

REVISIONS			
REV	DESCRIPTION	DATE	APPR
1	Added block height dimension (.660)	12/2/2011	ks

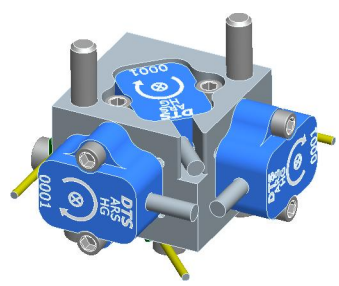

ARS MOUNTING SIDES

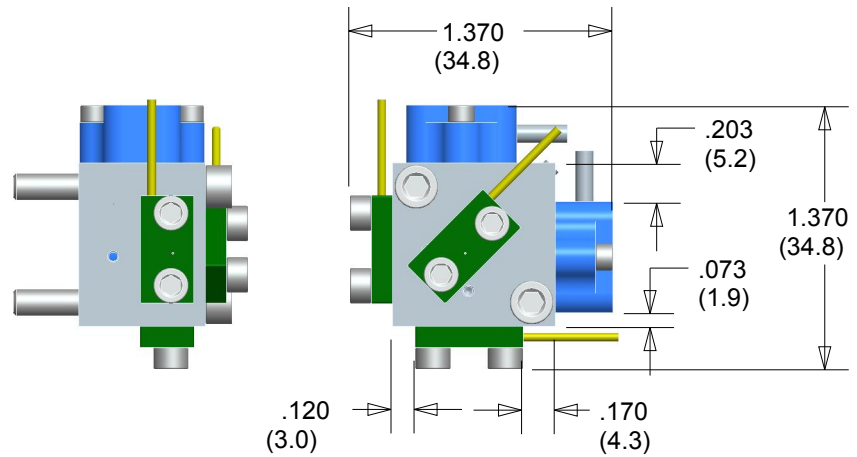
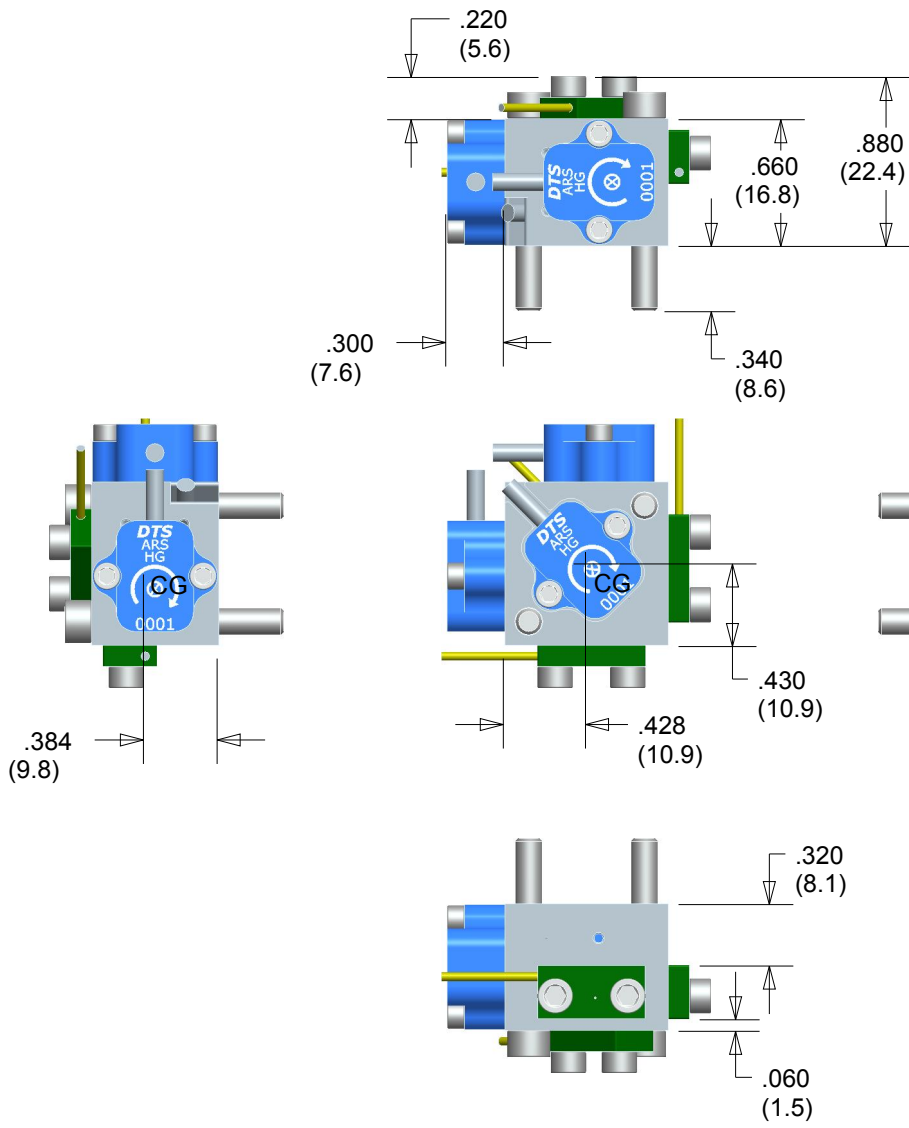
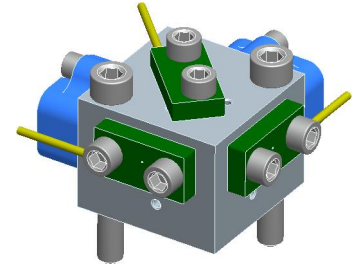

ACCEL MOUNTING SIDES

INCH (MM)

CENTER OF GRAVITY (WITH ALL DEVICES): $\pm .02$ (.5)

WEIGHT (WITH ALL DEVICES): $37.8 \pm .2$ GRAMS

RECOMMENDED SCREWS: #6-32 X 1 in (M3-0.5 X 25)

McMASTER PN: 91251A153 (91290A125)

RECOMMENDED TORQUE: 9.6 IN-LB ± 2 (.9 Nm) DRY (20% LESS IF LUBRICATED)

UNLESS OTHERWISE SPECIFIED
 DIMENSION ARE IN INCHES
 TOLERANCES ARE:
 FRACTIONS: DECIMALS: ANGLES: MACHINED:
 $\pm 1/64$.X $\pm .1$ $\pm 5^\circ$ 125
 .XX $\pm .01$
 .XXX $\pm .002$
 DO NOT SCALE DRAWING

DTS 909 ELECTRIC AVE, SUITE 206
 SEAL BEACH, CA 90740
 562-493-0158

NAME/DESC:
TRIAx BLOCK FOR ARS HG - WITH COMPONENTS

MATERIAL:
7075-T651 ALUMINUM

DRAWING NO:
 DRAWN BY:
 K SHOEMAKER 10-4-11
 SIZE: A
 SCALE: 1:1
 REV: 1
 SHEET: 1 OF 1