

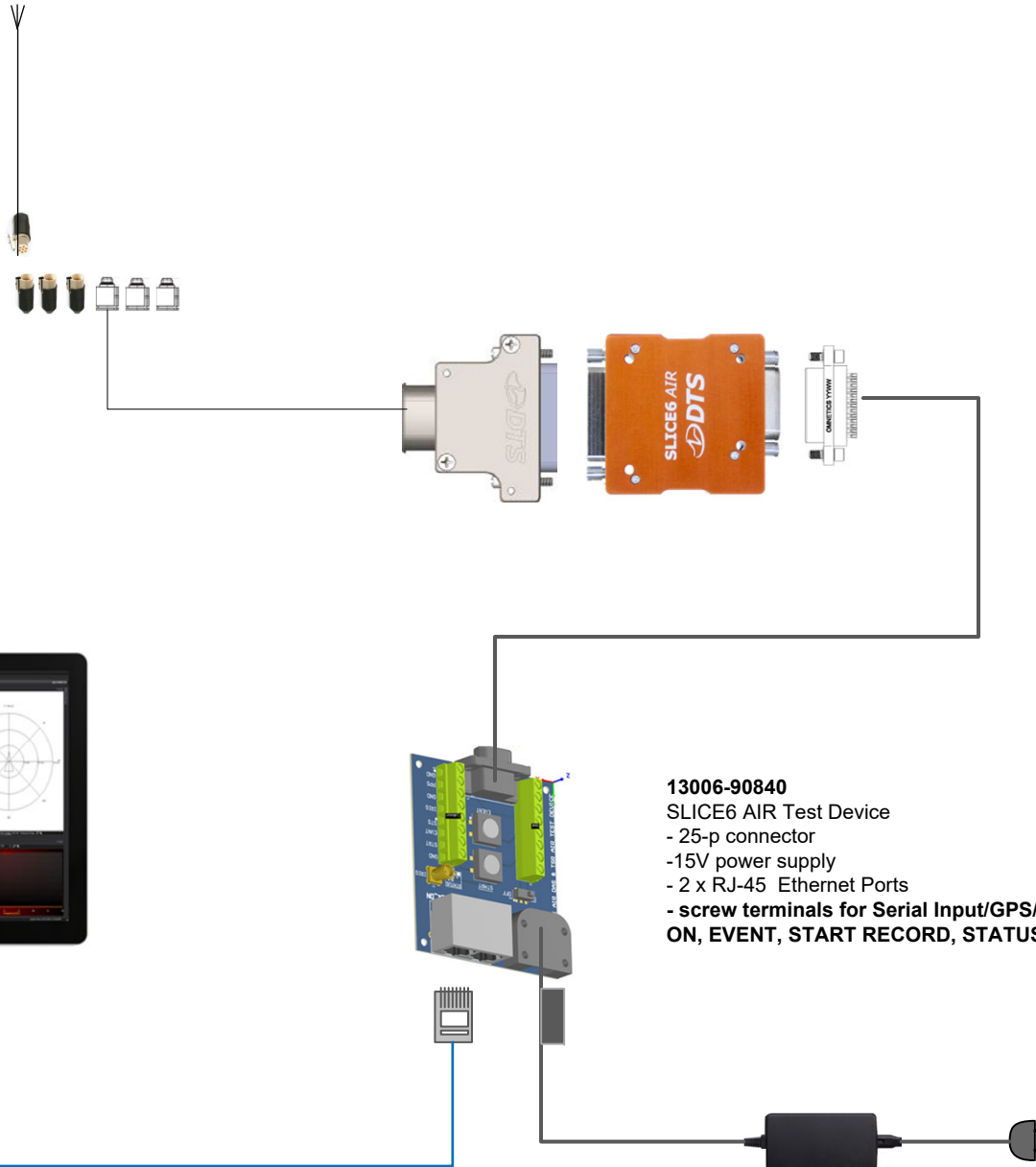

Application Diagram SLICE6 AIR Benchttop Kit – Test Device

13000-30121
1ch sensor cable assy
- 5m length
- pigtail termination
*available with 1/4 bridge completion resistor
(13000-30122, 90 in length)



13006-90840
SLICE6 AIR Test Device
- 25-p connector
- 15V power supply
- 2 x RJ-45 Ethernet Ports
- screw terminals for Serial Input/GPS/PPS/IRIG-B,
ON, EVENT, START RECORD, STATUS LED